

HA216

Vacuum breakers

Technical Data Sheet

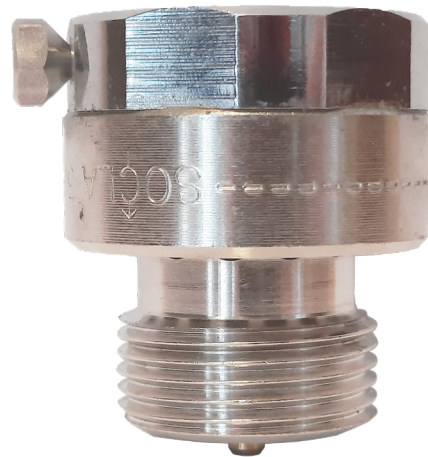

Description

These devices are double protection valves, containing the following in the flow direction, one non return valve, one vacuum breaker (tightness ensured by a membrane).

This vacuum breaker ensures that the downstream emptied when the flow is stopped and prevents the backflow of used water through a possible leak in the non return valve, in the event of depression in the mains.

- It allows a closing system downstream
- Operating position : vertical descendin
- Minimum head loss
- Silent, robust
- Does not generate hammering
- Closing system : axial guiding with release spring
- Sealing guaranteed by a flat seal



HA216

Vacumm breakers

DN		Ref.	Weight Kg
F "	M "		
3/4	3/4	149B2160	0,14
3/4	3/4	149B2161*	0,14

*chrome plated version

Technical features

Opprating temperature	-10 °C at 65 °C
Permissible operating pressure (PFA) in water	10 bar
Connection	Female/male, (BSP)
Mediums	Clear liquids

Nomenclature and materials

N°	Description	Materials	EURO
1	body	Brass	EN12164-CW617N-DW-R360
2	Spring	Stainless steel	EN10270-3-1.4310
3	Closing system	Brass	EN12164-CW617N-DW-R360
4	Membrane	EPDM	
5	Screw	Stainless steel	EN10088-3-1.4301
6	Seal	EPDM	

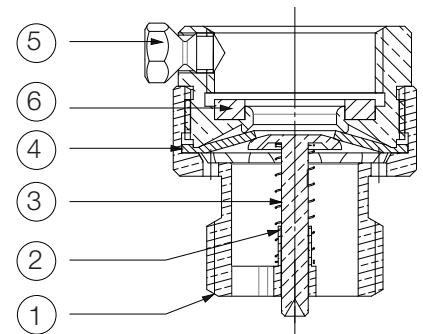

Application

Protection of drinking water networks garden taps.

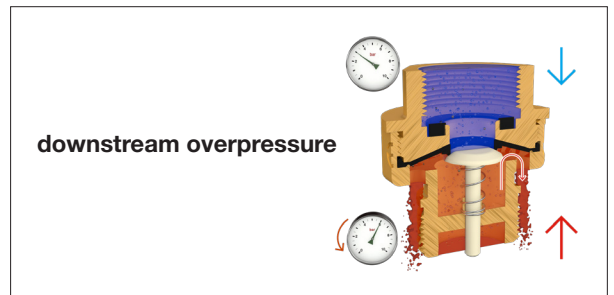
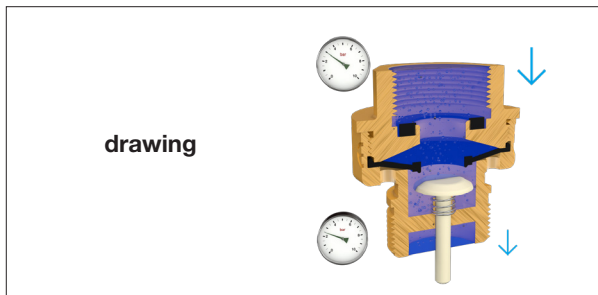

Operation

Direction for use :

- Solid line: Valve completely open
- Dotted line: opening stage of valve

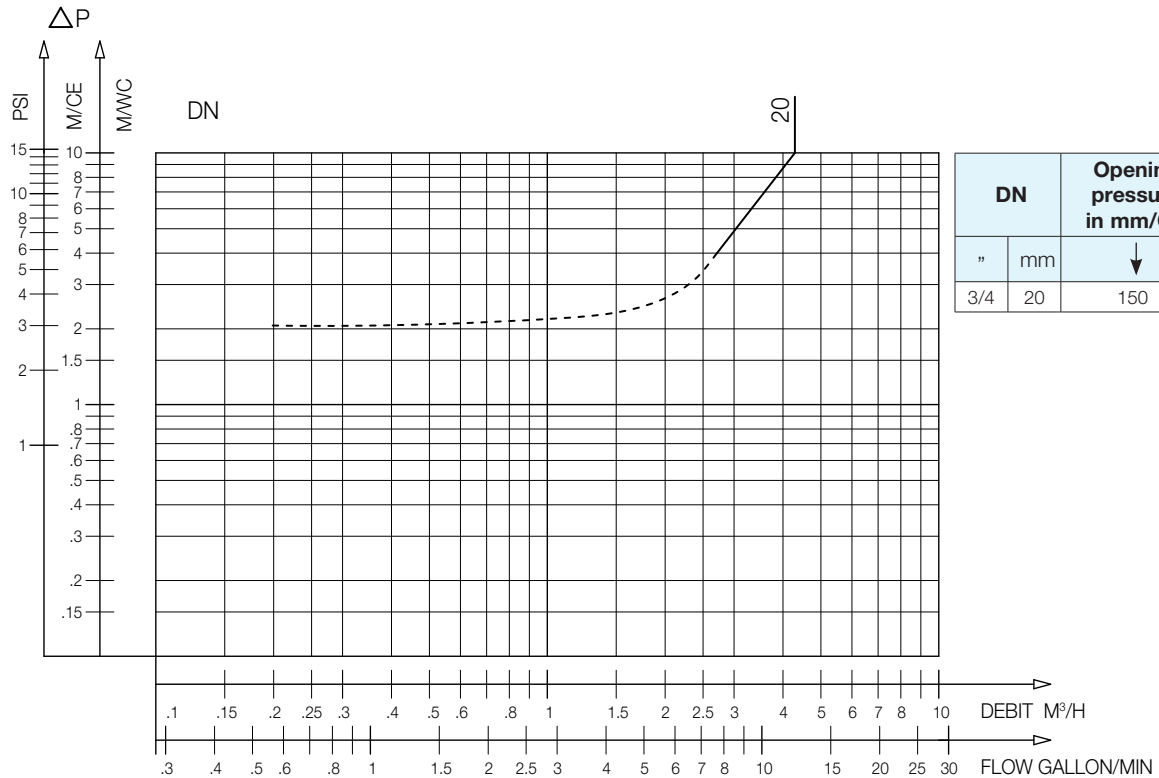

HA216 - Headloss chart

Sizing

A in "		B	C
Inlet F	Outlet M	mm	mm
3/4	3/4	41	37

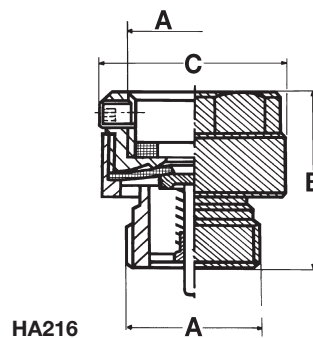

The descriptions and photographs contained in this product specification sheet are supplied by way of information only and are not binding.

Socla reserves the right to carry out any technical and design improvements to its products without prior notice. Warranty : All sales and contracts for sale are expressly conditioned on the buyer's assent to Socla terms and conditions found on its website at www.socla.com. Socla hereby objects to any term, different from or additional to Socla terms, contained in any buyer communication in any form, unless agreed to in a writing signed by an officer of Socla.



A WATTS Brand

Socla sas

365 rue du Lieutenant Putier • 71530 Virey-Le-Grand • France

Tel. +33 03 85 97 42 00 • Fax +33 03 85 97 42 42

contact@wattswater.com • www.socla.com

ISO 9001 version 2015 / ISO 18001