

Technical data sheet

Type 9BIS

Pressure reducing valve

Desbordes

Applications and special features



- Control and maintain the downstream pressure at an adjustable reduced value, whether there is a flow or not.
- Keep an outlet pressure at a constant value, even by variation of the upstream pressure (the down-stream pressure cannot vary more than 10 % of the variation of the upstream pressure, according to the Standard).
- No maintenance required, not affected by scale or dirt.
- Can be installed in any position.
- Guarantee a high flow rate at a constant outlet pressure because of low head loss.
- Work as pressure reducing valve (standard terminology) as well as "regulator" and as "pressure regulating valve" (when applies for gas).
- Non-adjustable set at 3 bar.
- With 1/4" plugs on both sides to allow pressure gauge connection.

Technical description

DN		PFA (bar)	PS (bar)				Cat.	References	Vvs-nr
"	mm		L1	L2	G1	G2			
1/2	15	25	25	25	X	25	3.3	149B7222	
3/4	20	25	25	25	X	25	3.3	149B7223	
1	25	25	25	25	X	25	3.3	149B7224	

L1, L2, G1 and G2 correspond to liquids/gas classified into degree of danger according to the Pressure Equipment Directive (PED). The article 3.3 applies to equipments with no CE marking.

- **Connection** : Female/female, BSP thread
- **Permissible operating pressure PFA - water** : See table
- **Maximum permissible pressure PS - other mediums** : See table
- **θ** : Mini. -10 °C
Maxi. in permanent service : 80 °C
- **Mediums** : Water, air and neutral gas
- **Approvals** : ACS - NF
- **International construction Standards** :
Pressure reducing valves EN 1567
Thread connection NF EN ISO 228

Overall dimensions

DN	D		A	B	E	G	Weight kg
	"	mm	mm	mm	mm	mm	
15	1/2	15/21	31	53	66,0	59	0,63
20	3/4	20/27	31	59	77	73	0,86
25	1	26/34	40	68	98	94	1,59

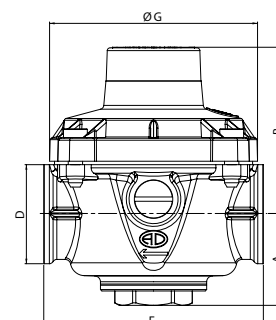

Technical data sheet **Type 9BIS - Pressure reducing valve**

Spare parts list and materials

Nb	Description	Material	EURO	ANSI
1	CASING	bronze	CuSn5Zn5Pb5-C	ASTM B 505
2	SEAT	Stainless steel (DN 15 - 20)	X8CrNiS18-09	AISI 303
3	O-RING	NBR (Nitrile)		
4	STIRRUP	Brass	CuZn40Pb2	
5	SEAL	NBR (Nitrile)		
6	STIRRUP PLUG	Brass	CuZn39Pb3	ASTM B 124
7	MEMBRANE	NBR / Polyamide		
8	MEMBRANE WASHER	Brass	CuZn39Pb3	ASTM B 124
9	COPPER WASHER	Copper		
10	MEMBRANE SCREW	Stainless steel	X5CrNi 18-10	AISI 304
11	SPRING	DZR brass	SH	
12	CAP	Brass	CuZn39Pb2	ASTM B 124
13	SCREW	Stainless steel	X5CrNi 18-10	AISI 304
14	NUT FOR SPRING PRESSING	Brass	CuZn39Pb3	ASTM B 124
15	PLASTIC COVER	Polyethylen		
16	CAP COVER	Brass	CuZn39Pb3	ASTM B 124
17	O-RING	NBR (Nitrile)		

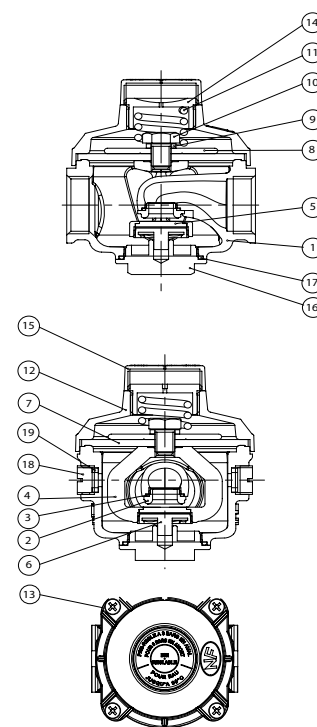

Working principle

• Pressure setting range

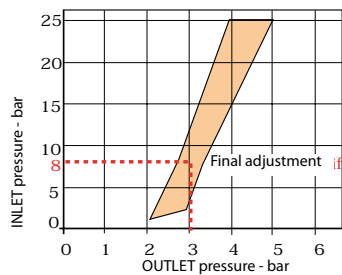

Dispersion area of final adjustment

• ACOUSTIC LEVEL : DS value Lap in dB(A). The higher the DS is, the quieter the machine/apparatus will be : **Our pressure reducing valves are very silent.**

	Lap values
1/2"	10 dB(A) up to 0,18 l/s
3/4"	16 dB(A) up to 0,32 l/s
1"	20 dB(A) up to 0,57 l/s

• Flow

Flow - m³/h

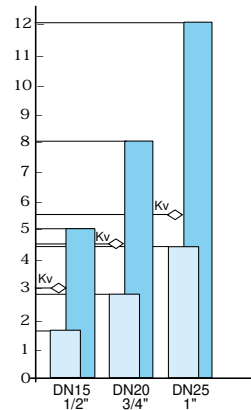

Flow at the velocity used in the Standard (2 m/s).

Maximum flow (at 0 outlet pressure) for upstream pressure of 8 bar.

Kv : Flow in m³/h when the outlet pressure becomes 1 bar lower than its setting at zero flow.

Socla can accept no responsibility for possible errors in catalogue, brochures and other printed material. Socla reserve the right to alter its products without notice. This also applies to products already agreed. All trademarks in this material are the property of the respective companies. All right reserved.

Socla SAS

365 rue du lieutenant Putier
71530 VIREY LE GRAND
Postal address : BP 10273
71107 CHALON SUR SAONE Cedex

Tel : 33 3 85 97 42 52
Fax : 33 3 85 97 97 42
<http://www.socla.com>
e-mail: commerfr@socla.com