

# Technical data sheet

## Type 402Z Non-return valve System 02

### Applications and special features



- Operates in any position
- Minimum head loss
- Silent, reliable sealing, compact
- Exceptional robustness
- Does not generate hammering
- Closing system : long back axial guiding for reduced displacement
- Sealing guaranteed by a flat seal
- Return spring

### Technical description

#### Important notice :

The indicated pressure for the different categories of fluids (L1/L2/G1/G2) is under no condition a guarantee of use. Therefore, it is essential to validate the use of products under given operating conditions.

DN "	mm	PN	PFA in bar	PS in bar				Cat.	References	Vvs-nr
				L1	L2	G1	G2			
1 1/2	40	10/25	25	25	25	25	25	I	149B 2337	
2	50	10/25	25	25	25	20	25	I	149B 2342	
2 1/2	65	10/16	16	16	16	15	16	I	149B 2343	
3	80	10/16	16	16	16	12	16	I	149B 2344	
4	100	10/16	16	16	16	10	16	I	149B 2345	
5	125	10/16	16	16	16	0,5	16	I	149B 15280	
6	150	10/16	16	13	16	0,5	16	I	149B 15364	
8	200	10	10	10	10	0,5	10	I	149B 15365	
10	250	10	10	10	10	0,5	10	I	149B 15719	
12	300	10	10	10	10	0,5	10	I	Spécial	
14	350	10	10	10	10	0,5	10	I	Spécial	
16	400	10	10	10	10	0,5	8	I	149B 24862	

- Connection : flanges drilled PN : see table
- Permissible operating pressure PFA - water- (for supply, distribution and disposal of water) : see table
- Maximum permissible pressure PS - other mediums: See table
- $\theta$  Mini. -10 °C  
Maxi. 100 °C
- Mediums : clear liquids, sea water, gas
- Approvals : ACS PED 97/23/CE
- International construction Standards :  
CE Conformity Directive 97/23/CE  
Flange drilling according to EN1092-2

### Overall dimensions

DN "	DN		B mm	C mm	D mm	Weight kg
	mm	mm				
1 1/2	40	85	80	150	4,2	
2	50	100	97	165	6	
2 1/2	65	120	125	185	8,7	
3	80	140	150	200	11,6	
4	100	170	187	220	16,4	
5	125	200	220	250	29	
6	150	230	260	285	38,6	
8	200	288	340	340	64	
10	250	354	420	405	113	
12	300	395	490	460	170	
14	350	472	586	533	272	
16	400	560	680	597	324	

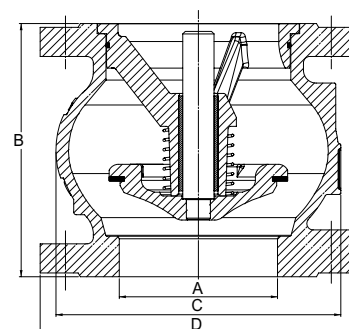

## Technical data sheet Type 402Z - Non-return valve

### Spare parts list and materials

Nb	Description	Materials	EURO	ANSI
1	CASING	Bronze	EN 1982 CuSn5Zn5Pb2-C GS	
2	GUIDE	Bronze	EN 1982 CuSn5Zn5Pb2-C GS	
3	SPRING	Stainless steel	EN 10270-3 X10CrNi18-8	AISI 302
4	SEAL	EPDM		
5	CLOSING SYSTEM	Bronze	EN 1982 CuSn5Zn5Pb2-C GS	

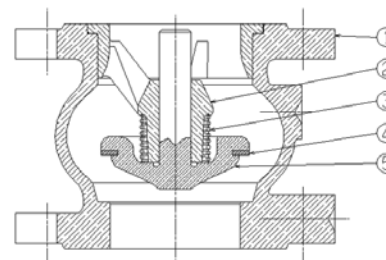

### Working principle

"	DN	Opening pressure in mm/WC				Kv m <sup>3</sup> /H	ζ
		↑	↓	↔	Without spring		
1 1/2	40	440	210	320	120	47,00	1,80
2	50	440	220	330	110	99,00	1,00
2 1/2	65	450	190	320	130	159,00	1,10
3	80	450	190	320	130	222,00	1,30
4	100	500	240	370	130	396,00	1,00
5	125	510	210	360	150	619,00	1,00
6	150	550	210	380	170	890,00	1,00
8	200	590	210	400	190	1120,00	2,00
10	250	710	210	460	250	2010,00	1,50
12	300	820	90	460	365	2459,00	2,10
14	350	860	100	480	380	2843,00	2,90
16	400	800	50	410	390	4370,00	2,10

#### Direction for use :

- Solid line : Valve completely open
- Dotted line : opening stage of valve

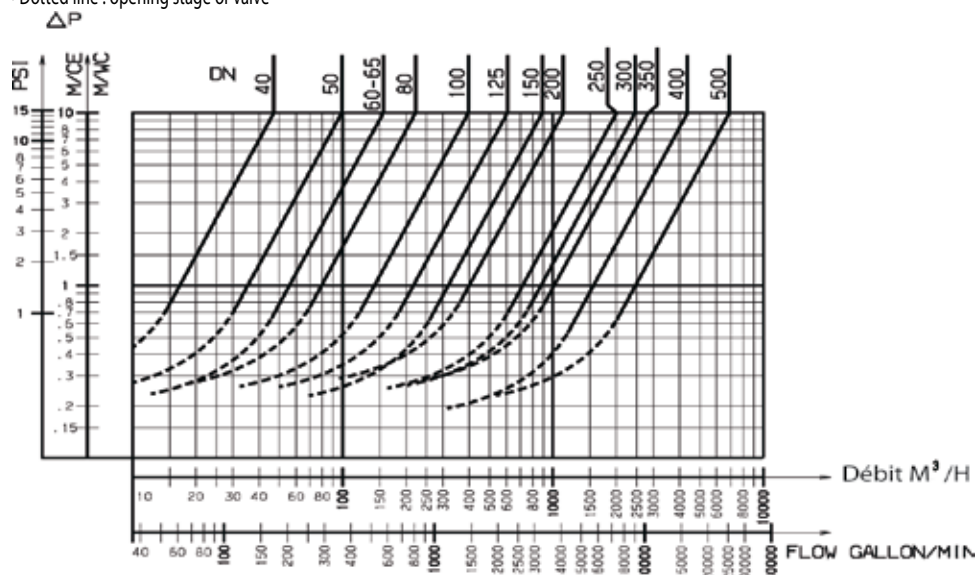

Socla can accept no responsibility for possible errors in catalogue, brochures and other printed material. Socla reserve the right to alter its products without notice. This also applies to products already agreed. All trademarks in this material are the property of the respective companies. All right reserved.

### Socla SAS

365 rue du lieutenant Putier  
71530 VIREY LE GRAND  
Postal address : BP 10273  
71107 CHALON SUR SAONE Cedex

Tel : 33 3 85 97 42 52  
Fax : 33 3 85 97 97 42  
<http://www.socla.com>  
e-mail: [commerfr@socla.com](mailto:commerfr@socla.com)