

Technical data sheet

Type 253

EA anti-pollution non-return valve
03 System

Applications and special features



- Approved according to EN 13959.
- Operates in any position.
- Excellent sealing at high as well as low pressure (NF).
- Drilled bosses with plug (DN 50 : 1/4" - DN 65 : 1/2").

Technical description

Important notice :

The indicated pressure for the different categories of fluids (L1/L2/G1/G2) is under no condition a guarantee of use. Therefore, it is essential to validate the use of products under given operating conditions.

DN mm	PFA bar	PS - bar				Cat.	References	Vvs-nr
		L1	L2	G1	G2			
50	16	16	16	15	16	I	149B 3810	
60	16	16	16	12	16	I	149B 3811	

- **Connection** : female/female, BSP thread
- **Permissible operating pressure PFA - water-** (for supply, distribution and disposal of water) : See table
- **Maximum permissible pressure PS - other mediums** : See table
- **θ** Mini - 10 °C
Maxi. 100 °C
- **Mediums** : Clear liquids, gas
- **Approvals** : ACS - PED 97/23/CE
- **International construction Standards** :
Thread connection according to NF EN 10226-1
NF Anti-pollution according to NF EN 13959
EN 1717

Overall dimensions

DN	A	B	C	D	Weight
mm	mm	mm	mm	mm	kg
50	2"1/2	147	104	58	2,6
65	3"	199	146	94,5	4,8

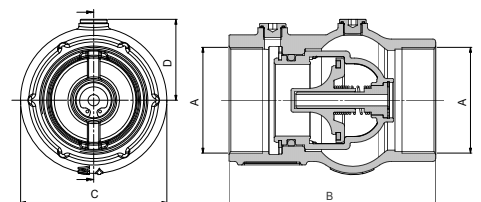

Technical data sheet Type 253 - EA antipollution non-return valve

Spare parts list and materials

N°	Description	Material	EURO	ANSI
1	CASING	Ductile iron + Epoxy	EN-GJS-400.15	ASTM A 536 65-45-12
2	CLOSING SYSTEM	DZR brass	CuZn36Pb2As	
3	SEAT	Stainless steel	GX5CrNi 19-10	AISI 304
4	FLAT SEAL	EPDM		
5	STEM	DZR brass	CuZn36Pb2As	
6	PLUG	Brass	CuZn39Pb3	
7	O-RING	EPDM		
8	SPRING	Stainless steel	X10CrNi18-8	AISI 302
9	CIRCLIPS	Stainless steel	X5CrNi 18-10	AISI 304
10	O-RING	EPDM		
11	CIRCLIPS	Stainless steel	X5CrNi 18-10	AISI 304

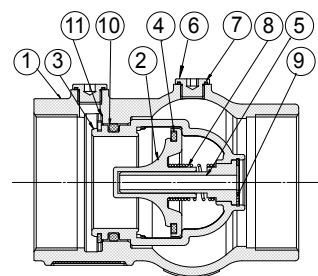

Working principle

DN	Opening pressure in mm/WC	Kv	ζ
mm		m ³ /H	
50		116	2,12
65		123	1,89

Directions for use :

- Solid line : Valve completely open

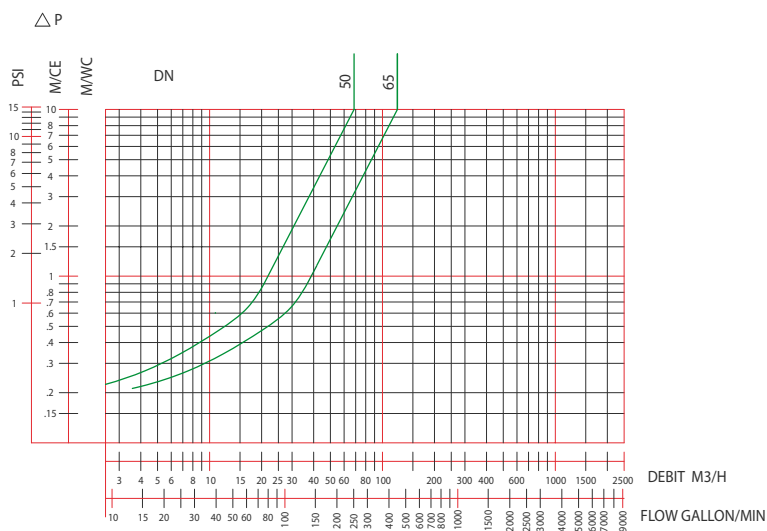

Socla can accept no responsibility for possible errors in catalogue, brochures and other printed material. Socla reserve the right to alter its products without notice. This also applies to products already agreed. All trademarks in this material are the property of the respective companies. All right reserved.

Socla SAS

365 rue du lieutenant Putier
71530 VIREY LE GRAND
Postal address : BP 10273
71107 CHALON SUR SAONE Cedex

Tel : 33 3 85 97 42 52
Fax : 33 3 85 97 97 42
<http://www.socla.com>
e-mail: commer@socla.com