

Technical data sheet

Type 10BIS BZ

Pressure reducing valve

Desbordes

Applications and special features



- Control and maintain the downstream pressure at an adjustable reduced value, whether there is a flow or not.
- Keep an outlet pressure at a constant value, even by variation of the upstream pressure (the down-stream pressure cannot vary more than 10 % of the variation of the upstream pressure, according to the Standard).
- All internal component in bronze, specially adapted for sea water and aggressive water.
- No maintenance required, not affected by scale or dirt.
- Can be installed in any position.
- Guarantee a high flow rate at a constant outlet pressure because of low head loss.
- Work as pressure reducing valve (standard terminology) as well as "regulator" and as "pressure regulating valve" (when applies for gas).
- Downstream setting : 1bar to 6 bar; indicative value according to EN1567
- Adjustable : supplied non adjusted.
- 2 pressure gauge connections 1/4" and drain at the bottom of the casing.

Technical description

DN	PFA (bar)	PS (bar)				Cat.	References	Vvs-nr
		L1	L2	G1	G2			
1	25	25	25	X	25	3.3	149B7013	
1 1/4	32	25	25	X	25	3.3	149B7014	
1 1/2	40	25	25	X	25	3.3	149B7015	
2	50	25	25	X	20	3.3	149B7016	
2 1/2	65	25	25	X	15	3.3	149B7017	
3	80	25	25	X	12	3.3	149B7018	

L1, L2, G1 and G2 correspond to liquids/gas classified into degree of danger according to the Pressure Equipment Directive (PED). The article 3.3 applies to equipments with no CE marking.

- Connection : female/female, BSP thread
- Downstream pressure gauge connection : 1/4"
- Permissible operating pressure PFA - water : See table
- Maximum permissible pressure PS - other mediums : See table
- θ : Mini. -10 °C
Maxi. in permanent service : 80 °C
(40°C domestic fuel oil)
- Mediums : water, sea water, aggressive water
- Approvals: ACS
- International construction Standards :
Pressure reducing valves EN 1567
Thread connection NF EN ISO 228

Overall dimensions

DN	D		A	B	C	G	Weight
	"	mm	mm	mm	mm	mm	kg
25	1	26/34	60	160	123	123	2,70
32	1 1/4	33/42	77	180	155	155	4,80
40	1 1/2	40/49	84	205	172	172	6,50
50	2	50/60	105	235	198	198	9,80
65	2 1/2	66/76	118	270	215	215	13,50
80	3	80/90	143	300	234	234	17,90

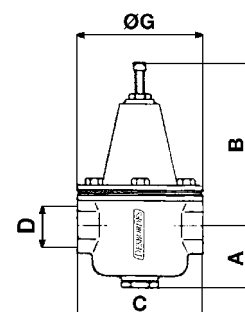

Technical data sheet Type 10BIS BZ - Pressure reducing valve

Spare parts list and materials

Nb	Description	Material	EURO	ANSI
1	CASING	Bronze	CuSn5Zn5Pb5 - C	ASTM B 505
2	CAP COVER	Bronze	CuSn5Zn5Pb5 - C	ASTM B 505
3	SEAL	NBR (Nitrile) or fibre		
4	SPRING	Anticorrosive steel	SH ou VD CrSi	
5	PLATE	Brass	CuZn39Pb3	
6	CAP	Brass or alu-bronze or bronze	CuZn39Pb1 CuAl9 or CuSn5Zn5Pb5	
7	SCREW	Stainless steel	X5CrNi 18-10	AISI 304
8	ADJUSTING SCREW	Stainless steel	X5CrNi 18-10	AISI 304
9	NUT	Stainless steel	X5CrNi 18-10	AISI 304
10	MEMBRANE	NBR/Polyamide		
11	MEMBRANE WASHER	Bronze	CuSn5Zn5Pb5 - C	ASTM B 505
12	STIRRUP	Alu-bronze or Messing DZR or Bronze	CuAl9 CuZn36Pb2As CuSn5Zn5Pb5	
13	SEAL	NBR (Nitrile)		
14	SCREW	Stainless steel	X5CrNi 18-10	AISI 304
15	SEAL	NBR (Nitrile)		
16	PLUG	Messing DZR	CuZn36Pb2As	

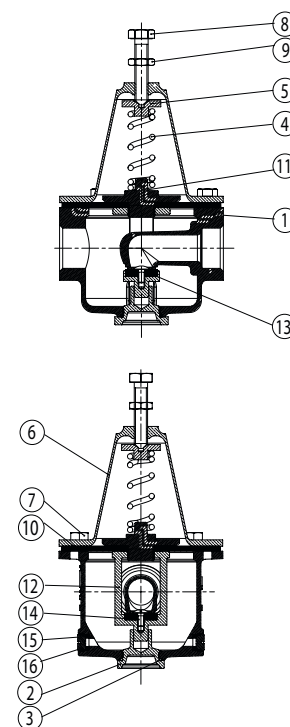

Working principle

• Pressure setting range

(DN 25 - 80 mm)

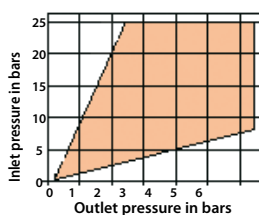

• Flow capacity

Flow at the velocity used in the Standard (2 m/s).

Maximum flow (at 0 outlet pressure) for upstream pressure of 8 bar.

Kv : Flow in m³/h when the outlet pressure becomes 1 bar lower than its setting at zero flow.

Flow in m³/h

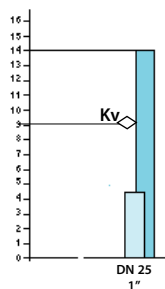

Flow in m³/h

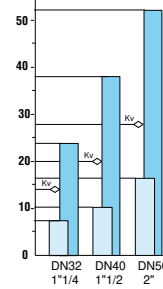

Flow in m³/h

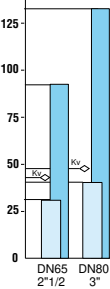

Socla can accept no responsibility for possible errors in catalogue, brochures and other printed material. Socla reserve the right to alter its products without notice. This also applies to products already agreed. All trademarks in this material are the property of the respective companies. All right reserved.

Socla SAS

365 rue du lieutenant Putier
71530 VIREY LE GRAND
Postal address : BP 10273
71107 CHALON SUR SAONE Cedex

Tel : 33 3 85 97 42 52
Fax : 33 3 85 97 97 42
<http://www.socla.com>
e-mail: commerfr@socla.com