

EA 453

EA antipollution non-return valves
System 03

Technical Data Sheet



Description

The non-return valve EA 453 is certified to the NF antipollution norms. This non-return valve is designed for the protection of drinking water network against polluted backflow which has no recognized toxic or microbiological risks to human health. It is particularly suitable for mounting after watermeter.

- Approval according to EN 13959
- Operates in any position
- Excellent sealing at high as well as low pressure (NF)
- Inspection cover to check and replace internal parts without dismantling the device
- Interchangeable closing kit without specific tools
- 2 drilled bosses with test cocks 1/2" (except DN 40/50 : 1/4")
- 1 boss with drain plug 1/2" (except DN 40/50 : 1/4")



EA 453

EA antipollution non-return valves - System 03

DN mm	PFA in bar	PS in bar				Cat.	Ref.	Weight Kg
		L1	L2	G1	G2			
40/50	16	16	16	16	16	I	149B3831	7,65
60/65	16	16	16	15	16	I	149B3832	11,45
80	16	16	16	12	16	I	149B3833	14,36
100	16	16	16	10	16	I	149B3834	20,2
150	16	16	16	0,5	16	I	149B3836	42
200	10	10	10	0,5	10	I	149B3837	65
250	10	10	10	0,5	10	I	149B3838	94

Important notice :

The indicated pressure for the different categories of fluids (L1/L2/G1/G2) is under no condition a guarantee of use. Therefore, it is essential to validate the use of products under given operating conditions.

Technical features

Operating temperature	-10 °C at 100 °C
Permissible operating pressure (PFA) in water	See table above
Maximum permissible pressure (PS) other mediums	See table above
Connection	With flange (see table)
Mediums	Clear water, gas

Nomenclature and materials

N°	Description	Materials	EURO	ANSI
1	Body	Cast iron/Epoxy	EN1563 EN-GJS-400.15	ASTM A 536 65-45-12
2	Closing system	Brass (Ø50 at 150) Bronze (Ø200-250)	EN1265-CW625N-DW-H070 EN1982-CC499K-GS	
3	Seat	Stainless steel	EN10213-1.4308+AT	AISI 304
4	Flat seal	Silicone		
5	Stem	Brass (Ø50 at 150) Brass (Ø200) Bronze (Ø250)	EN1265-CW625N-DW-H070 EN12164-CW625N-DW-R320 EN1982-CC499K-GS	
6	Valve	Brass (Ø50) Brass (Ø65 at 250)	EN12165-CW625N-DW-H070 EN12165-CW617N-DW-H080	
7	Plug	Brass	EN12164-CW625N-DW-R320	
8	O-ring	EPDM	EPDM	
9	Cap	Cast iron/Epoxy	EN1563 EN-GJS-400.15	ASTM A 536 65-45-12
10	Screw	Stainless steel	EN10088-3-1.4301	AISI 304
11	Washer	Stainless steel	EN10088-3-1.4301	AISI 304
12	Spring	Stainless steel	ISO6981-1-4325 302-00-E	AISI 302
13	Circlips	Stainless steel	EN10088-3-1.4301	AISI 304
14	Cover	PE	POLYETHYLENE	
15	O-ring	EPDM	EPDM	
16	Lift ring	Steel (Ø150 at 250)	EN10025-S235JR	
17	Nut	Stainless steel (Ø150 at 250)	EN10088-3-1.4301	AISI 304
18	Washer	Stainless steel (Ø150 at 250)	EN10088-3-1.4301	AISI 304

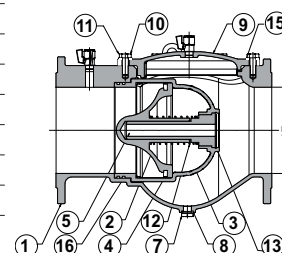
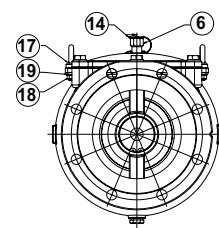

Approvals



International construction Standards :

Flanges connection according to EN 1092-1 and EN 1092-2

Sizing according to EN558-1 series 48

CE conformity directive according to 2014/68/UE

NF antipollution according to NF EN 13959 - EN1717

Application

Housing, water distribution, protection of drinking water networks.

Operation

Direction for use :

- Solid line: Valve completely open
- Dotted line: opening stage of valve

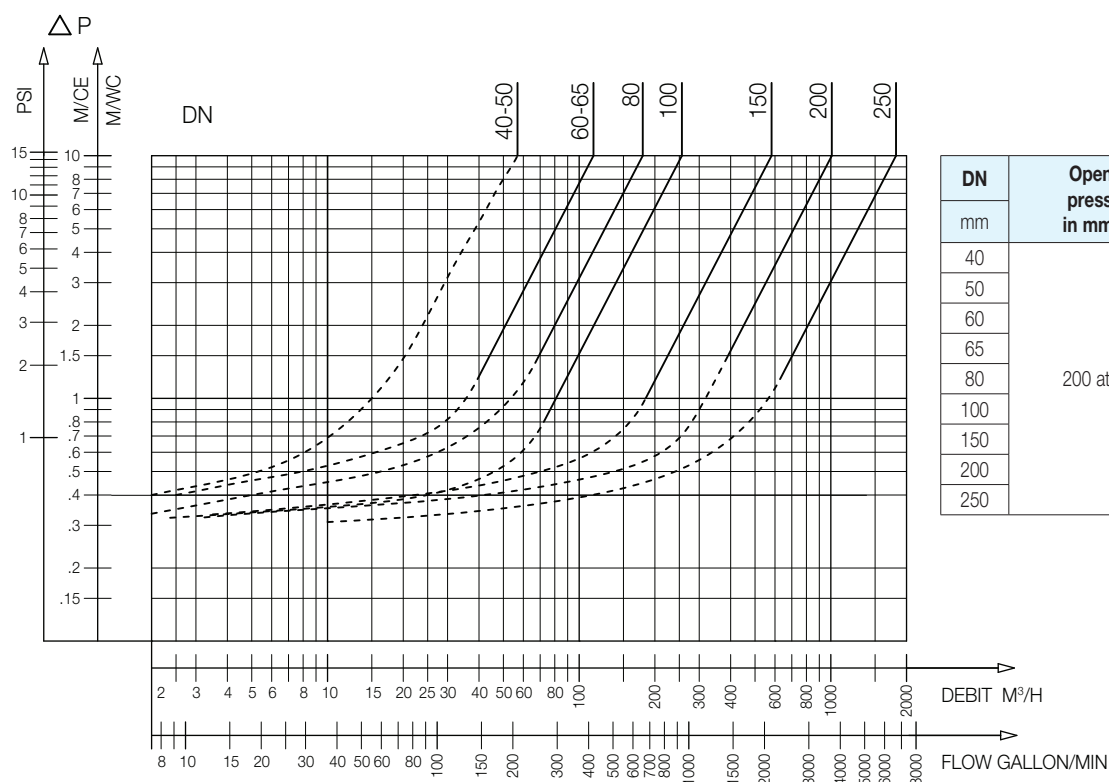

DN	Opening pressure in mm/CE	Kv	ζ
mm		m ³ /H	
40	200 at 400	56,9	1,85
50		56,9	3,1
60		114,6	1,57
65		114,6	2,2
80		179,1	2,05
100		256,9	2,4
150		581,7	2,4
200		1009	2,5
250		1816,9	1,9

EA 453 - Headloss chart

Sizing

A	B	C	D	E	F
mm	mm	mm	mm	mm	mm
40/50	165	-	200	113	80
60/65	185	-	240	118	93
80	200	-	260	131	98
100	222	-	300	141	115
150	285	-	400	197	144
200	340	380	500	220	200
250	400	438	600	256	235

EA 453

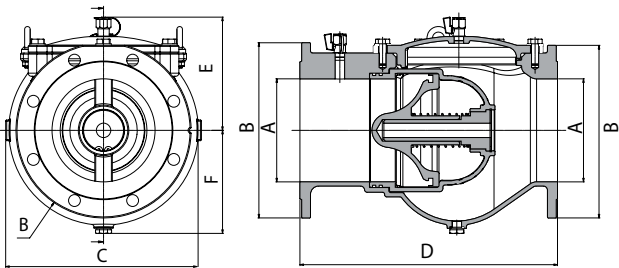

The descriptions and photographs contained in this product specification sheet are supplied by way of information only and are not binding.

Socla reserves the right to carry out any technical and design improvements to its products without prior notice. Warranty : All sales and contracts for sale are expressly conditioned on the buyer's assent to Socla terms and conditions found on its website at www.socla.com. Socla hereby objects to any term, different from or additional to Socla terms, contained in any buyer communication in any form, unless agreed to in a writing signed by an officer of Socla.



Socla sas
365 rue du Lieutenant Putier • 71530 Virey-Le-Grand • France
Tel. +33 03 85 97 42 00 • Fax +33 03 85 97 42 42
contact@wattswater.com • www.socla.com
ISO 9001 version 2015 / ISO 18001